

BILL OF MATERIALS			ITEM NO.	QTY REQ'D	DESCRIPTIONS	MAT'L SPEC.
1	1	SHELL- 16" OD SCH. 80 (0.843" WALL) SML'S PIPE	SA-106B			
2	2	HEADS- 16" OD x 0.83" MIN x 2:1 SE c/w 2" SF (0.75" NOM)	SA-516-70N			
3	1	SKIRT- 16" OD SCH. 10 (0.25" WALL) ERW PIPE	SA-53-B			
4	1	BASE PLATE- 22" OD x 12" ID x 1/2" PLATE	SA/CSA 640.21-44W			
5	1	FLOAT SHIELD- 1/4" THK. PLATE x 16" SQ.	SA/CSA 640.21-44W			
6	1	INLET DIVERTER- 2" SCH. 80 x 90° LR	SA-234-WPB			
7	1	MISTEX- 4" THK. x 9#/FT <sup>2</sup> x 14 5/16" OD	316 LSS			
8	2	RINGS- 14 3/16" OD x 12 3/16" ID x 1/4" THK. PLATE	SA/CSA 640.21-44W			
9	2	XPM- #4 x 14 3/16" OD	SA/CSA 640.21-44W			
10	1	NAME PLATE BRACKET- 3/16" THK. PLATE	SA/CSA 640.21-44W			
N3	1	FLG- 2" 600# RFWN SCH. 160	SA-105N			
2	PCS	NECK- 2" SCH. 160 SML'S PIPE (CUT TO SUIT)	SA-106B			
1		ELBOW- 2" SCH. 160 x 90 LR	SA-234-WPB			
C2	1	TOL- 2" 3000# NPT	SA-105N			
C3 A	2	TOL- 3/4" 6000# NPT	SA-105N			
C4	1	TOL- 2" 3000# NPT	SA-105N			
C5	1	TOL- 3/4" 6000# NPT	SA-105N			
C6	1	TOL- 1/2" 6000# NPT	SA-105N			
C7	1	TOL- 2" 3000# NPT c/w PLUG	SA-105N			
C8 A	2	TOL- 3/4" 6000# NPT	SA-105N			
C9	1	TOL- 2" 3000# NPT	SA-105N			
C10	1	TOL- 2" 3000# NPT	SA-105N			
C11	1	TOL- 1" 3000# NPT	SA-105N			
C12	1	TOL- 1" 3000# NPT	SA-105N			
C13	1	TOL- 1" 3000# NPT	SA-105N			
ALTERNATE CONN. "N1", "N2"						
N1	1	FLG- 2" 600# RFWN SCH. 160	SA-105N			
1	PC	NECK- 2" SCH. 160 SML'S PIPE	SA-106B			
1		ELBOW- 2" SCH. 160 x 90 LR	SA-234-WPB			
N2	1	FLG- 2" 600# RFWN SCH. 160	SA-105N			
1	PC	NECK- 2" SCH. 160 SML'S PIPE	SA-106B			

ITEM NO.	NO. REQ'D	SIZE	RATING	SERVICE	WELDING DETAIL	WELD SIZE	INT. PROJ.
N3	1	2"	600#	DRAIN	N1, S7, F1	3/8"	
C2	1	2"	3000#	INSP.	C4	3/8"	
C3 A	2	3/4"	6000#	LG COND.	C4	3/8"	
C4	1	2"	3000#	HLSD	C4	3/8"	
C5	1	3/4"	6000#	TI	C4	3/8"	
C6	1	1/2"	6000#	PI	C4	3/8"	
C7	1	2"	3000#	INSP.	C4	3/8"	
C8 A	2	3/4"	6000#	LG WATER	C4	3/8"	
C9	1	2"	3000#	LC WATER	C4	3/8"	
C10	1	2"	3000#	LC COND.	C4	3/8"	
C11	1	1"	3000#	COND. OUT	C4	3/8"	
C12	1	1"	3000#	PSV	C4	3/8"	
C13	1	1"	3000#	WATER OUT	C4	3/8"	
ALTERNATE CONN. FOR "N1" & "N2"							
N1	1	2"	600#	INLET	N2, F1, S7	3/8"	1 1/2"
N2	1	2"	600#	OUTLET	N1, F1	3/8"	

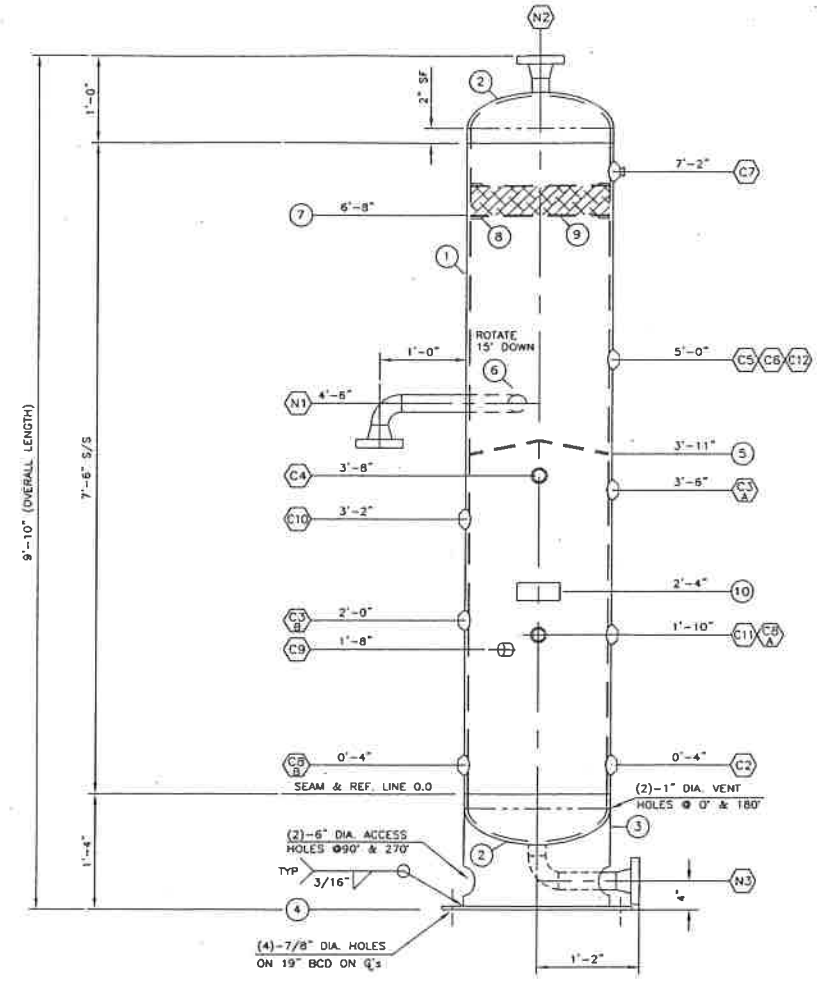

ELEVATION

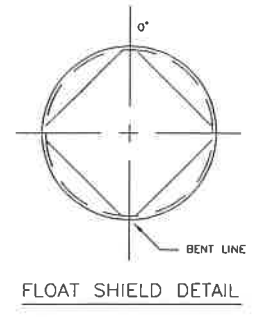

Float shield detail

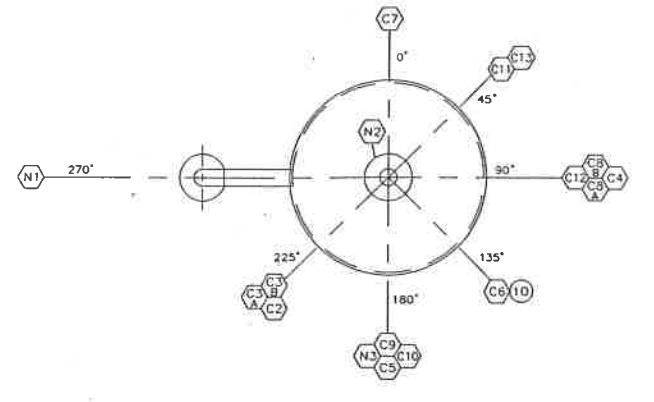

ORIENTATION (RUSHTON STANDARD)

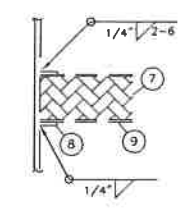

MISTEX SUPPORT DETAIL

GENERAL NOTES :

- VESSEL TO BE THOROUGHLY DRAINED & CLEANED WITH ALL OPENINGS PLUGGED BEFORE SHIPMENT.
- ALL BOLT HOLE TO STRADDLE NATURAL Q'S UNLESS NOTED.
- EXPOSED INSIDE EDGES OF NOZZLES TO BE ROUNDED OR CHAMFERED
- ALL DIMENSIONS ARE TO REFERENCE LINE UNLESS NOTED.
- CIRC SM. USE WELD DETAIL "S7"
- IMPACT TEST NOT REQUIRED AS PER UG-20-(1) 1-5 & UCS-66(C)
- MINIMUM DESIGN METAL TEMPERATURE, -20° F @ 1440 PSIG.
- ALTERNATE DESIGN TO USE ALL CPLG 3000# NPT. (6000# FOR 3/4" CONN. & UNDER) USING HALF CPLG. FOR 2" 3000#.
- HEADS TO BE HOT-FORMED.
- RUSHTON REF. WELD PROC. R1 REV.2, R-3 REV.2, R-11
- VESSEL CALC'S HAVE CONSIDERED ALL APPLICABLE LOADINGS IN ACCORDANCE WITH UG-22
- MAX. DRILLED HOLE ON HD. OR SHL. FOR 2" TOL SHALL BE 2.205" DIA

SPECIFICATIONS

VESSSEL TO BE DESIGNED AND CONSTRUCTED IN ACCORDANCE WITH THE ASME CODE SECTION VIII, DIVISION 1, PARA UW-11(a)-5(b), 2004 EDITION

CODE STAMP REQ'D. YES C.R.N. P1396.231 C.A.-SHELL 0.085" HEAD 0.085"

DESIGN PRESSURE 1440 PSIG @ -20/130° F WEIGHT EMPTY 1700 LBS.

WORKING PRESSURE @ WEIGHT FLOODED 2386 LBS.

RADIOGRAPHY RT-2 LONG CIRC. 70% VOLUME 11 CU. FT. JOINT EFF. JOINT EFF.

STRESS RELIEVE MIN. HYDRO TEST 2160 PSIG

HEAD SPEC. SA-516-70N 0.63" MIN. (0.75" NOM.)

SHELL SPEC. SA-106B SML'S - SCH 80 (0.843" NOM.)

PAINT SEE PIPING PLAN NOTES

(2) REQ'D TIME CARD C-2631-VS

SN# C-2502<sup>H</sup>.VS

DWG. NO.	REFERENCE DRAWINGS	REV	DESCRIPTION	DATE	BY
		A	WELDING DETAIL FOR NOZZ. "N2" WAS "N1"	09/12/00	T.S.
		A	UPDATED TO CURRENT ADD.	04/10/01	T.S.
		A	UPDATED TO CURRENT EDITION	01/18/02	T.S.
		A	UPDATED TO CURRENT ADDENDA	03/12/03	T.S.
		A	UPDATED TO CURRENT ADDENDA.	01/12/04	T.S.
		A	UPDATED TO CURRENT EDITION	01/06/05	T.S.



CUSTOMER: DEVON CANADA CORPORATION		LOCATION: 12-30-34-15-W4M	
c/o HATCH OPTIMA		09-08-39-18-W4M	
<b>VERTICAL SEPARATOR</b>			
16" OD x 7'-6" s/s 1440 PSIG x -20/130 °F, 0.085" C.A.			
FOR JOB# "C-2631" ONLY			
DATE: 05/01/00	DRN BY: Y.P.	SCALE: 1"=1'-0"	CHKD BY: APPRD BY: DWG NO: C-16SR-AB